

Job Name:	
System Reference:	Date:



Indoor Unit: MSZ-FE12NA-8



Wireless Remote Controller

GENERAL FEATURES

- Updated sleek, compact indoor unit design
- Includes Standard, Platinum Deodorizing, and Anti-allergy Enzyme Filters for a complete air purifying system
- “Powerful Mode” function permits system to temporarily run at a lower/higher temperature with an increased fan speed, which quickly brings the room to the optimum comfort level
- Integrated i-see sensor automatically detects room air temperature
- Autochangeover for cooling and heating
- Hand-held Wireless Remote Controller
- Limited warranty: five years parts and seven years compressors

ACCESSORIES

Indoor Unit

- Condensate Pump (BlueDiamond X87-711/721; 115/230V)
- Condensate Pump (Saueremann SI30-115/230; 115/230V)
- Replacement Platinum Deodorizing Filter (MAC-308FT)
- Replacement Anti-allergy Enzyme Filter (MAC-418FT; MERV 8)

Controller Options

- Wireless Controller (MHK1)
- Wired Remote Controller PAR-31MAA (Requires MAC-333IF-E)
- Wireless Interface for kumo cloud™ (PAC-WHS01WF-E)
- Thermostat Interface (PAC-US444CN-1)

SPECIFICATIONS

Cooling Capacity* 12,000 Btu/h

Heating Capacity* 13,600 Btu/h

*** Rating Conditions per AHRI Standard**

Cooling | Indoor: 80° F (27° C) DB / 67° F (19° C) WB

Cooling | Outdoor: 95° F (35° C) DB / 75° F (24° C) WB

Heating at 47°F | Indoor: 70° F (21° C) DB / 60° F (16° C) WB

Heating at 47°F | Outdoor: 47° F (8° C) DB / 43° F (6° C) WB

(For data on specific indoor units [all ducted, all non-ducted, and both ducted and non-ducted] combinations, see the MXZ-B Technical and Service Manual.)

Applications should be restricted to comfort cooling only; equipment cooling applications are not recommended for low ambient temperature conditions.

Electrical Requirements

Power Supply 208 / 230V, 1-Phase, 60 Hz

MCA 1 A

Voltage

Indoor - Outdoor S1-S2 AC 208 / 230V

Indoor - Outdoor S2-S3 DC +/- 24V

Blower Motor (ECM) 0.76 F.L.A.

Airflow

Cooling (Lo - Med - Hi - Powerful) 162 - 226 - 381 - 410 Dry CFM

144 - 202 - 305 - 367 Wet CFM

Heating (Lo - Med - Hi - Powerful) 166 - 240 - 399 - 420 Dry CFM

Sound Pressure Level (Lo - Med - Hi - Powerful)

Cooling 22 - 33 - 43 - 45 dB(A)

Heating 22 - 33 - 43 - 44 dB(A)

DIMENSIONS	UNIT INCHES / MM
W	31-7/16 / 799
D	10-1/8 / 257
H	11-5/8 / 295

Weight 27 lbs. / 12 kg

External Finish Munsell No. 1.0Y 9.2 / 0.2

Field Drainpipe Size O.D. 5/8" / 15.88 mm

Refrigerant Type R410A

Refrigerant Pipe Size O.D.

Gas Side 3/8" / 9.52 mm

Liquid Side 1/4" / 6.35 mm

Connection Method Flared

DIMENSIONS: MSZ-FE12NA-8

Unit: inch

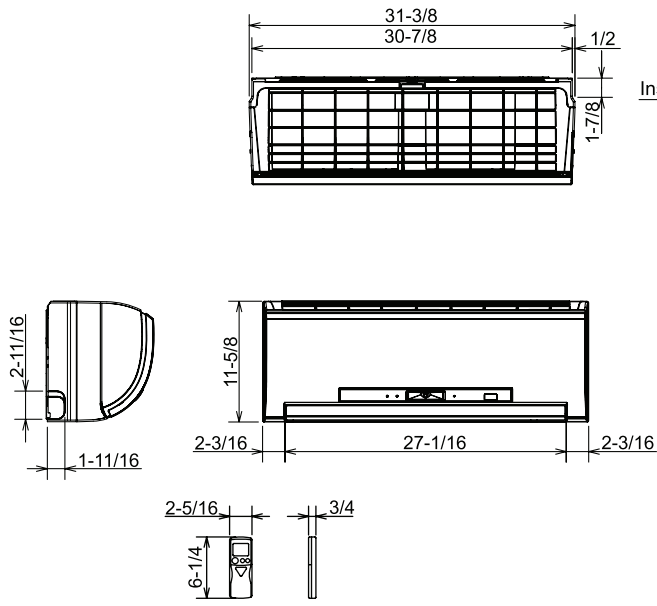

Piping	Insulation	ø1-3/8 O.D
	Liquid line	ø1/4 19-11/16 (Flared connection ø1/4)
	Gas line	ø3/8 16-15/16 (Flared connection ø3/8)
	Drain hose	Insulation ø1-1/8 O.D Connected part ø5/8 O.D

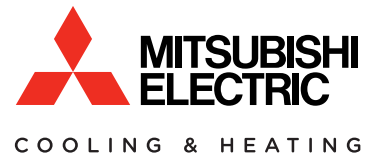
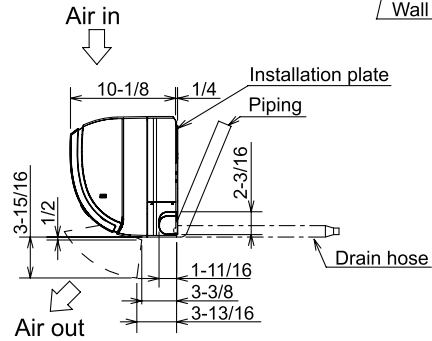
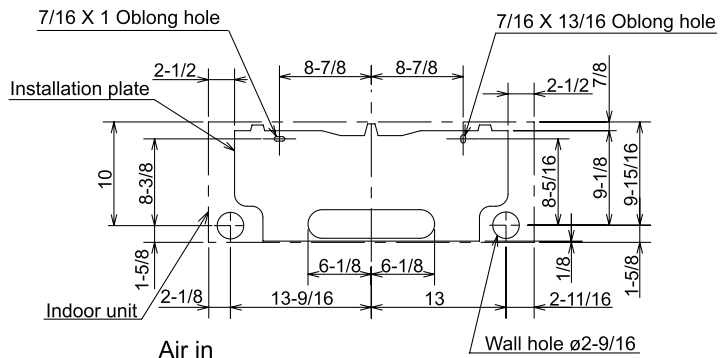

1340 Satellite Boulevard, Suwanee, GA 30024
Toll Free: 800-433-4822 www.mehvac.com

